

CHECK CONDITION OF SHIPMENT

Upon receipt of this kit, check the condition of the packaging. Damage to the package should be noted on the carrier's freight receipt. Any damage claims as a result of shipping must be handled through the shipper. Travis Industries will provide assistance in resolving shipping claims or replacing items not included in the package. Please report any missing items immediately.

COMPATIBILITY

- Travis Ind. DVL Insert or DVL Fireplace using the Cambridge Face

PACKING LIST

- Fan Light
- Fan Light Brackets
- Two 10-24 Screws

INSTALLATION INSTRUCTIONS

- ! Turn the gas control valve to "OFF" prior to conducting any service.
- 1 Remove the face and glass (see the owner's manual).
- 2 Install the fan light following the directions below.

NOTE:

The face and glass must be removed prior to installing the fan light.

(a)

Use the included screws to install the fan light mounting brackets to the insert (they attach to the inside). You may wish to pre-thread the holes on the insert prior to installation.

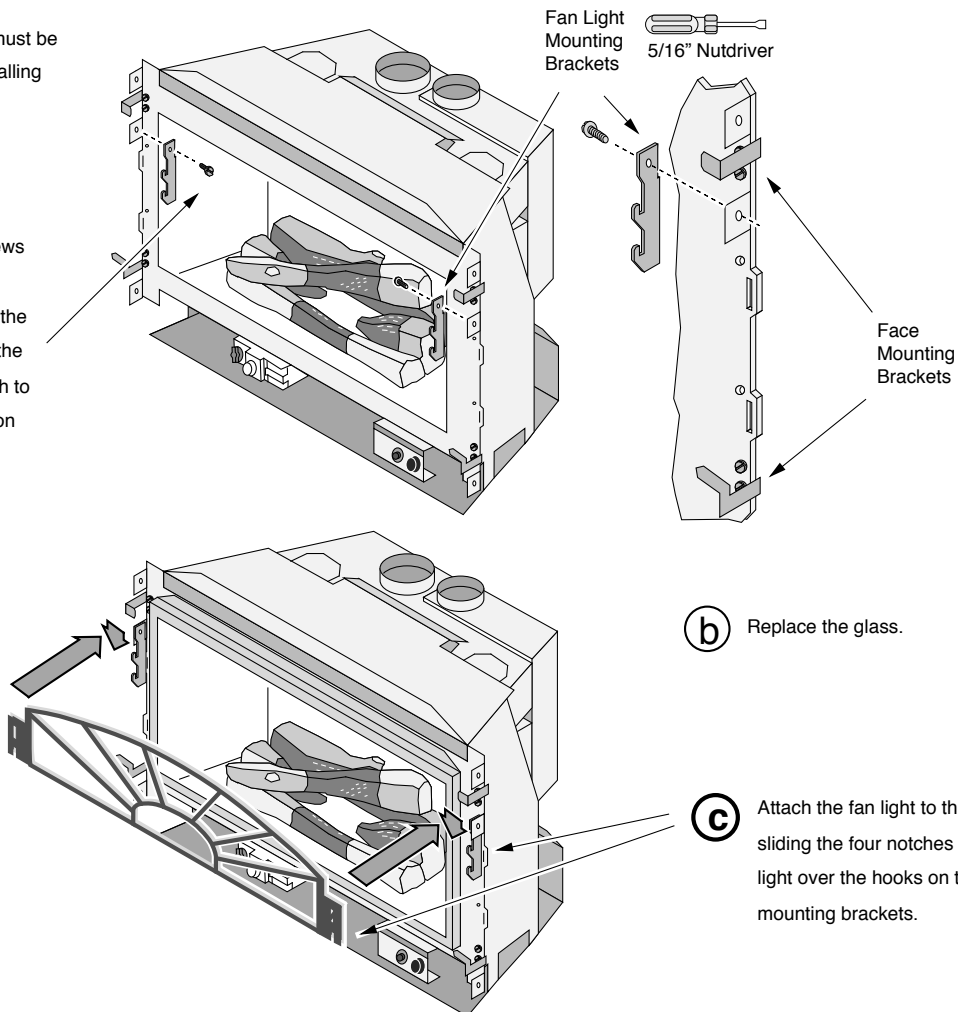

(b) Replace the glass.

(c) Attach the fan light to the heater by sliding the four notches on the fan light over the hooks on the fanlight mounting brackets.

IMPORTANT NOTE REGARDING GOLD SURFACES

Prior to starting the heater, clean the gold surface with a soft cloth and denatured alcohol. Any marks left on the gold surface will permanently etch the gold if heated.